

Compact Machining Center for Electric Car Battery

DST 40DS DST 42DS



2-HEADS TAPPING CENTER



Two Heads Operation

- ▶ Increased productivity and decreased cost
- ▶ Reduced time of Loading/Unloading
- ▶ Minimized area of installation
 - Reduced investment cost

NOMURA DS Compact Machining Center DST 40DS | DST 42DS

Main spindle

2 surface restraint type [BBT 30] –Taper & Flange Contact

Ceramic bearing and optimized pre-load setting in main spindle increases rigidity, speed and low heat emission to maintain stable accuracy in long time high speed machining
High output main motor as standard maximizes productivity

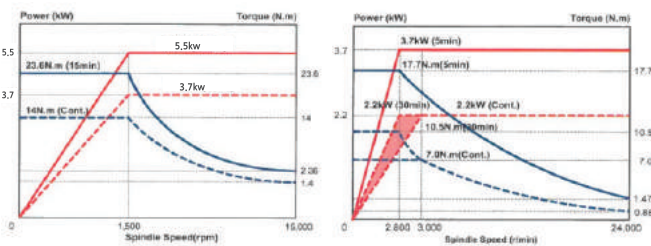
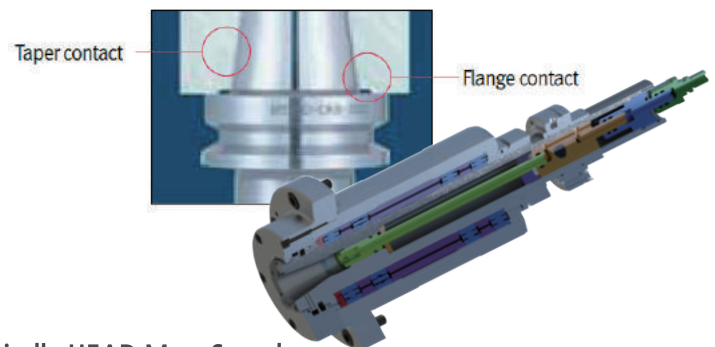

Main Spindle HEAD Max. Speed

Standard : 15,000rpm

Option : 24,000rpm (No optional chiller required)

2-HEAD OFFSET

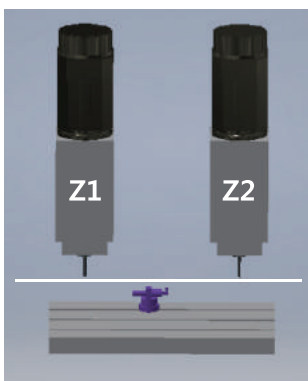

- Extra Z1, Z2 function
- Reduced tool setting time
 - Precise position correction by one-touch

Controller (convenience)



- The latest NC Mitsubishi M80
- Increased operation speed with high speed PLC engine
 - Reduced cycle time

High-productivity Auto Tool Changer[ATC]

Twin Arm Magazine minimizes tool change time by using ATC

Number of tools	Tool change time(T-T /C-T-C)
20 / 24 Tool	1.1 sec. / 1.9 sec.

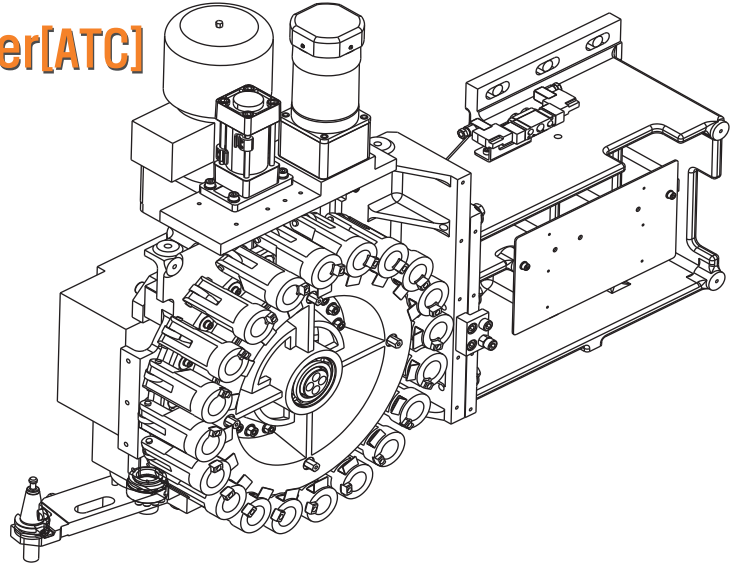

High rigidity structure

- ▶ High rigidity structure design through FEM analysis
- ▶ Minimized vibration during cutting feed
- ▶ Optimized structure for column moving type

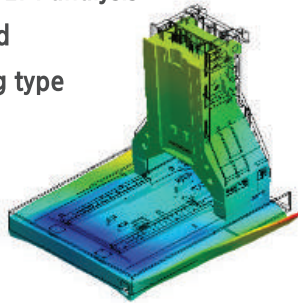

< Structure analysis -Stress >

Ball Screw & LM Guide

- Precision Ball screw (X/Y/Z Axis) adopted
- Improved machining capacity and durability with high-rigid roller guide

Travel distance and Max. Travel speed

- X/Y/Z-AXIS - 540 / 400 / 400 (40DS)
- 720 / 420 / 480 (42DS)
- Max Travel speed(X/Y/Z) - 60 M/min



Table Size

- 750 x 400 (40DS)
- 1040 x 420 (42DS)
(Wide workspace)

Outside view of the machine

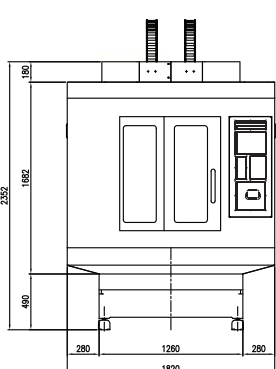

< DST 40DS >

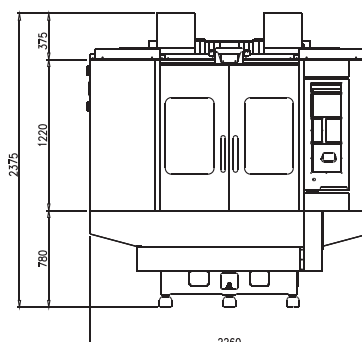
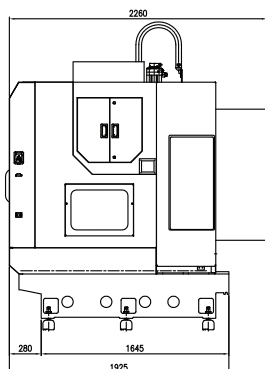

< DST 42DS >

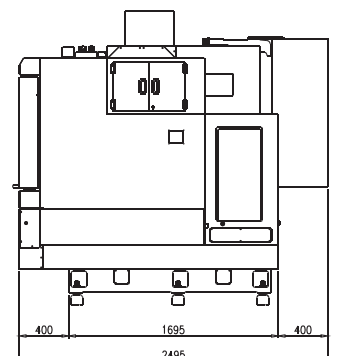

· Machine Specification

Item		DST-40DS	DST-42DS	Remark
Capacity	X-axis travel	mm	540	720
	Y-axis travel	mm	400	420
	Z-axis travel	mm	400	480
Table	Work Area (Table Size)	mm	750 X 400	1,040 X 420
	Work Height (Max.)	mm	250	300
Spindle	Spindle Max. RPM	rpm	15,000/24,000 (Standard/Option)	
	Spindle output	kW	5.5/3.7	
	Spindle Taper	-	7/24 Taper (BBT 30)	
Feed rate	Rapid Feed Rate	m/mim	60 / 60 / 60	
ATC unit	Tool Selection Method	-	Twin Arm	
	Pull Stud Type	-	MAS403-BT30 / MAS P30T-1	
	Number of Tools	POT	20/24 (Standard/Option)	
	Tool Max. Dia	mm	φ60	
	Tool Max. Length	mm	190	
	Tool Max. Weight	kg	3	
	Tool Selection	-	Random	
Electric / Utility	Power Supply	V	220V (50/60Hz)	
	Power Capacity	KVA	26	
	Air Pressure	Mpa	0.4 ~ 0.6	
Machine	M/C Size (W x L x H)	mm	1,820 X 2,260	2,260 X 2,495
	M/C Weight	kg	4,200	5,500
Controller	CNC	-	MITSUBISHI	

DST 40DS / 42DS	STANDARD	OPTION
	* Max Speed 15,000 min-1	* Max Speed 24,000 min-1
	* Signal Light (LED operation lamp)	* Oil Skimmer
	* Splash Guard	* Through Coolant System
	* Coolant Tank & Chip Bucket	* Chip Conveyor (L/ R /Rear) Scraper & Hinge Type
	* Flood / Bed Shower	* Hydraulic System
	* Portable MPG	* Accessary (Coolant Gun, Air Gun, Transformer)
	* Installation Parts and One Standard Work Tool	* Auto Door
	* Auto Tool Length Measuring Gauge	* 4 axis rotary Table

DAESUNG HI-TECH CO., LTD.

- DAESUNG HI-TECH** 10, Techno-daero 2-gil, Hyeonpung-eup, Dalseong-gun, Daegu 43020, Korea
TEL.+82-53-608-3662 / FAX.+82-53-592-6577
- NOMURADS** 3-1-12, IMAI, OME-CITY, TOKYO198-0023, JAPAN
TEL.+81-428-30-1313 / FAX.+81-428-30-1312
- DAESUNG HI-TECH VINA** TS9 Street, Tien Son Industrial Zone, Tuong Giang Commune, Tu Son Town, Bac Ninh Province
TEL.+84-241-3734-4125~6 / FAX.+84-241-3734-4124
- HanzungNC** Xuling Village, Xinhua Street, Zhuanghe city, Dalian Liaoning Province, China(Xinhua Industrial Zone)
TEL.+86-411-89812963 / FAX.+86-411-89812962
- German office** Ludwig-Erhard-Str. 30-34, 65760 Eschborn, Germany
TEL.+49-6196-969-5946 / E-mail.info@nomurads.de

Specifications may be subject to change without prior notice (for the purpose of quality improvement and function)